

VICINITY MAP
N.T.S.

LEGAL DESCRIPTION:

LOT 2 OF ROWLEY SHORT PLAT AS RECORDED UNDER AUDITOR'S FILE NUMBER 200709040043 IN BOOK 1 OF SHORT PLATS ON PAGE 235 OF KITTITAS COUNTY RECORDS, SW QUARTER OF NW QUARTER OF SECTION 13, TOWNSHIP 18 N., RANGE 17 E., W.M.

LOT COVERAGE NOTE:

TOTAL EXISTING IMPERVIOUS IMPROVEMENTS AREA = 2.00 AC.
 TOTAL ADDITIONAL PROPOSED IMPROVEMENTS AREA = 0.03 AC.
 TOTAL PARCEL AREA = 2.39 AC.
 IMPERVIOUS COVERAGE = ((2.00+0.03)/2.39)X100 = 84.94%

PROJECT SITE INFORMATION:

OWNER: SHREE HOLDINGS LLC
 P.O. BOX 5160
 MOSES LAKE, WA 98837

DEVELOPER: JOE PARK CONSTRUCTION
 405 W. WALNUT STREET
 YAKIMA, WA 98902

PARCEL NUMBER: 953186 (18-17-13051-0002)
PARCEL SIZE: 2.39 AC.
PROPERTY ADDRESS: 410 GLADMAR ROAD
 THORPE, WA 98946

ZONE: HIGHWAY COMMERCIAL ZONE (C-H)
CRITICAL AREAS: NONE

FIRE: FIRE DISTRICT 1 (RURAL THORPE)
WATER: GROUP A TNC WATER SYSTEM (THORPE ARCO AM/PM)
SEWER: PRIVATE

HATCH LEGEND:

- PROPOSED AC PAVEMENT
- EXISTING CONCRETE SURFACING
- PROPOSED CONCRETE SIDEWALK
- PROPOSED BUILDING HATCH

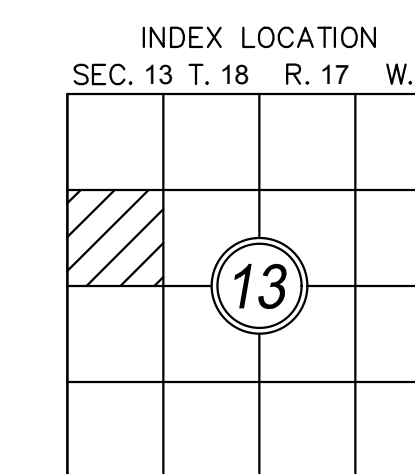

TOPOGRAPHIC AND BOUNDARY NOTE:

TOPOGRAPHIC SURVEY INFORMATION SHOWN HEREON WAS PREPARED BY CYPHER LAND SURVEYING, 502 N. 40TH AVENUE, SUITE 3, YAKIMA, WA 98908, IN OCTOBER 2019 AND PROVIDED TO LESLIE ENGINEERING ON OCTOBER 10, 2019. BOUNDARY SURVEY INFORMATION SHOWN HEREON IS FOR REFERENCE ONLY. LESLIE ENGINEERING DOES NOT GUARANTEE THE ACCURACY OF EXISTING INFORMATION SHOWN HEREON.



Know what's below.
Call before you dig.

THIS DOCUMENT IS THE PROPERTY OF
 LESLIE ENGINEERING, LLC
 ANY USE OF OR REPRODUCTION WITHOUT
 WRITTEN PERMISSION IS PROHIBITED



10/21/19

**THORPE CONVENIENCE
 STORE ADDITION**
 410 GLADMAR RD
 THORPE, WA 98946

PREPARED FOR

JOE PARK CONST.
 405 W. WALNUT ST.
 YAKIMA, WA 98902

NO.	DATE	DESCRIPTION

SITE PLAN

C100